

SPECIFICATIONS

| | |
|--|-----------------|
| Thermodynamic Cycle | Diesel 4 stroke |
| Air Handling | TAA |
| Arrangement | 4L |
| Bore x Stroke (mm) | 104 X 132 |
| Total Displacement (l) | 4,5 |
| Valves per cylinder (n°) | 4 |
| Cooling System | liquid |
| Direction of Rotation (viewed facing flywheel) | CCW |
| Compression ratio | 17:1 |
| Injection System | ECR |

PERFORMANCE

| | |
|---|--------------------|
| Rated power [*] (kW (HP) @ rpm) | 125 (170) @ 2200 |
| Peak power (kW (HP) @ rpm) | 129 (176) @ 2000 |
| Peak torque (Nm (kgm) @ rpm) | 700 (71) @ 1500 |
| High idle speed (rpm) | 2375 |
| Low idle speed (rpm) | ± 800 |
| DEF[**]/AdBlue consumption at peak torque and rated power (% of fuel cons.) | 4-5 |
| Minimum starting temperature without auxiliaries (°C) | -15 ° |
| Oil and oil filter maintenance interval for replacement [***] (hours) | 600 |

STANDARD CONFIGURATION

| | |
|--|--|
| Flywheel housing (type) | SAE 3 - cast iron |
| Flywheel size (inch) | 11" ½ |
| Intake manifold location | high / left side / vertical from top |
| Exhaust manifold location | high / right side / front |
| Turbocharger | fixed geometry with waste gate valve |
| Turbocharger location | high / back / right side |
| Fan transmission ratio | 1.4:1 |
| Distance between fan - crankshaft centers (mm) | X = 0 Y = 296 |
| Fuel filter (n°) | single cartridge - left side |
| Fuel prefilter | - |
| Fuel Pump | - |
| Oil filter (n°) | single cartridge - right side |
| Oil sump | suspended sheet steel / front sump, 35° angularity limits continuous in all directions |
| Oil vapours blow-by circuit | flywheel housing, Mann & Hummel valve |
| Oil heat exchanger | integrated into the block |
| Oil filler | on valve cover |
| Starter | 24V - 4kW |
| Alternator | 24V - 70A with W contact |
| Engine stop device | incorporated in the pump |
| Wiring harness | - |
| Painting color | grey |

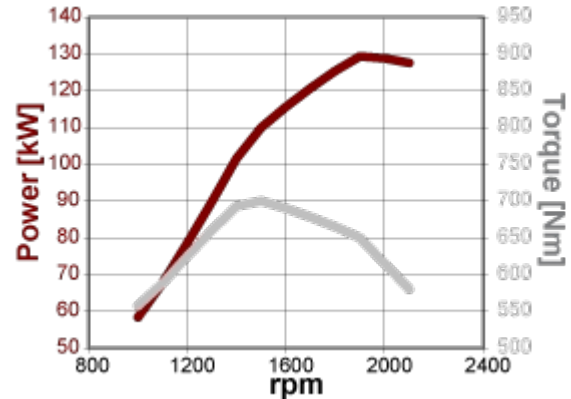

WEIGHT AND DIMENSIONS



Dry Weight
(standard configuration without:
oil, cooling, starter, clutch,
Compressor A/C, alternator) =
Kg 425

L = 833 mm
W = 685 mm
H = 955 mm

NOT INCLUDED IN STANDARD CONFIGURATION

| | |
|--|--|
| Power Take Off (PTO) | - |
| PTO - transmission ratio | 1.03:1 |
| PTO - maximum available torque | SAE A 100Nm (9 teeth) - 150Nm (11 teeth) SAE B 240Nm (13 teeth) |
| Battery - minimum capacity recommended [*] (Ah) | 130Ah (24V) |
| Battery - minimum cold cranking capacity recommended [*] (A) | 500A (24V) |

[*] Power at flywheel according to 97/68 EC (without fan), after 50 hours running, 3% tolerance.

[**] DEF: Diesel Exhaust Fluid.

[***] Oil type: Approved engine oil specification: 15W-40 ACEA E7 / API CI-4 or 10W-30 ACEA E7 / API CI-4.

Legend

| | | | | | |
|-----------------------------------|---|---|--|---|---|
| Arrangement L (in line) | Air Handling TAA (Turbocharged with aftercooler) TC (Turbocharged) NA (Naturally Aspirated) | Turbocharger WG (Wastegate) VGT (Variable Geometry Turbocharger) TST (Twin Stage Turbocharge) | Injection System M (Mechanical): ECR (Electronic Common Rail) EUI (Electronic Unit Injector) | Emission Standard EEV (Enhanced Environmentally friendly Vehicle) | Exhaust System EGR (Exhaust Gas Recirculation) SCR (Selective Catalytic Reduction) |
|-----------------------------------|---|---|--|---|---|

FOR INFORMATION ON THE AVAILABLE RATINGS NOT LISTED IN THIS DOCUMENT PLEASE CONTACT THE FPT INDUSTRIAL SALES NETWORK OR VISIT OUR SITE WWW.FPTINDUSTRIAL.COM



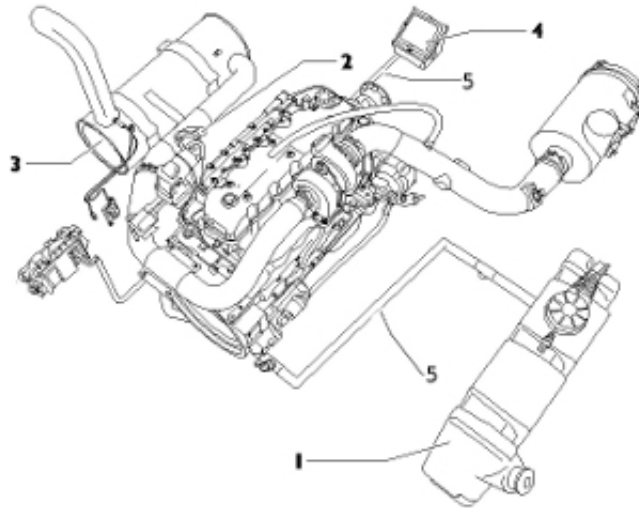

SCR (Selective Catalytic Reduction) system

Main components

- 1) AdBlue/DEF* Tank: available options 43 and 61 liters
- 2) Dosing Module
- 3) SCR muffler: available options Vertical and Horizontal configuration
- 4) Supply Module
- 5) AdBlue/DEF* pipes

*DEF: Diesel Exhaust Fluid

FPT INDUSTRIAL OFFERS THE WIDEST AVAILABILITY OF ENGINE BUILD OPTIONS TO CUSTOMER SPECIFIC REQUIREMENTS WITHIN THE ENGINE SUPPLY. TO FIND OUT MORE ABOUT THE CONFIGURATIONS AND ACCESSORIES WHICH ARE AVAILABLE

